

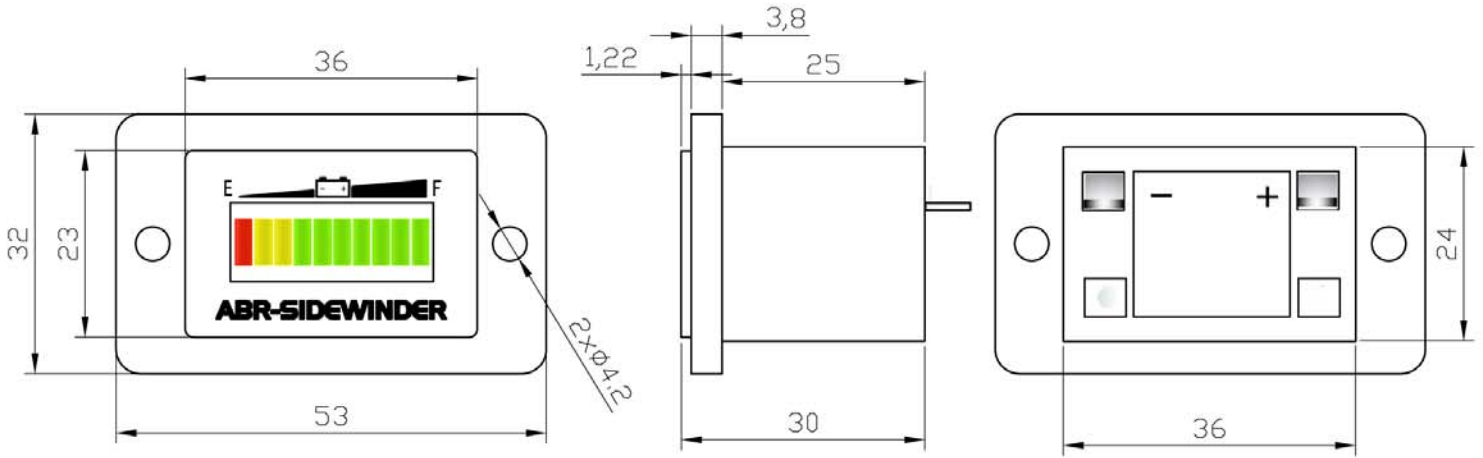

ABR - SIDEWINDER

INSTRUCTIONS FOR:

12V/24V BATTERY FUEL GAUGE



Remarks:

1. Indicating range follows the specs in Table-1; 12/24V integrated
2. In discharging: as battery voltage drops, the successive LED lighted, only one at a time.
3. In charging: as battery voltage rises, instrument will not reset (#10 LED will not be lighted) until it detects battery voltage reaches HVR volts and keep it for 6 min.
4. Battery swap: new battery is at OCR volts, #10 LED is lighted.

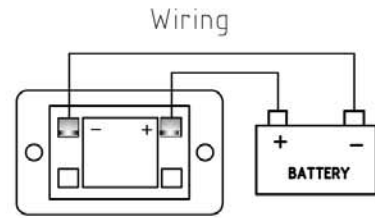

Panel Cutout

Technical Specifications

1. Operating voltage: $\pm 25\%$ of nominal voltage
Operating current: Nom. 25mA, Max.30mA
2. Case material ABS(BLK);
Lens: transparent PC;
Terminals: 2 (Max. 3) 3/16" spade
Panel cutout: 37x24.5mm
Hardware: 2 insulators & slapon connectors
3. Operating temperature: $-40 \sim 80^{\circ}\text{C}$ Storage: $-50 \sim 90^{\circ}\text{C}$
Humidity: 95%RH(Non condensing)@38°C
4. Totally sealed IP65
5. Voltage per cell: 1.84 ~ 2.09V HRV 2.25VPC
6. Memory features
7. SAE J1455, CE certificated

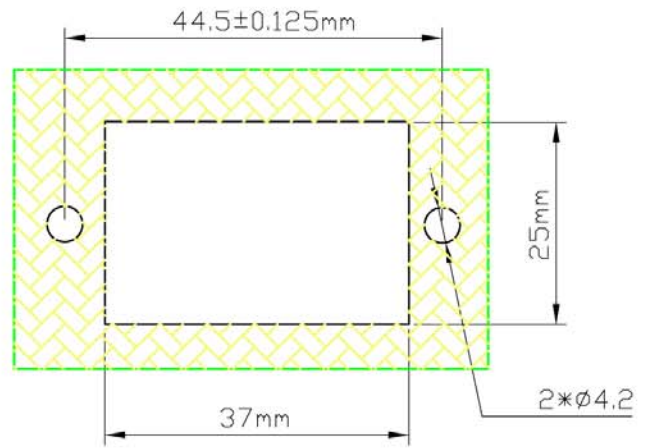

Label

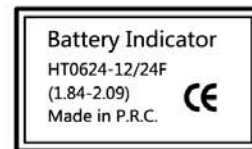

Volts	1#-2#	2#	3#	4#	5#	6#	7#	8#	9#	10#OCR	HVR
Color	Red/Yellow	Yellow	Yellow	Green	Green	Green	Green	Green	Green	Green	Green
12V	≤ 11.04	11.04~11.21	11.21~11.37	11.37~11.54	11.54~11.71	11.71~11.87	11.87~12.04	12.04~12.21	12.21~12.54	≥ 12.54	≥ 13.5
24V	≤ 22.08	22.08~22.41	22.41~22.75	22.75~23.08	23.08~23.41	23.41~23.75	23.75~24.08	24.08~24.41	24.41~25.08	≥ 25.08	≥ 27.0
Reset time	N/A	N/A	N/A	N/A	N/A	N/A	N/A	N/A	N/A	OCR: 2s	HVR: 6 min
Decreasing time	160s	160s	160s	160s	160s	160s	160s	160s	160s	160s	160s
Display	Flash by turns	Flashes	Lighted	Lighted	Lighted	Lighted	Lighted	Lighted	Lighted	Lighted	

OCR: Open circuit reset (Battery swap) HVR: High voltage reset (Charging)



ABR - SIDEWINDER
P.O.Box 4065, Gumdale, QLD, 4154
www.sidewinder.com.au

(07) 3890 5899

Email: info@sidewinder.com.au